

F RELAY LOCATIONS

[Engine Compartment]

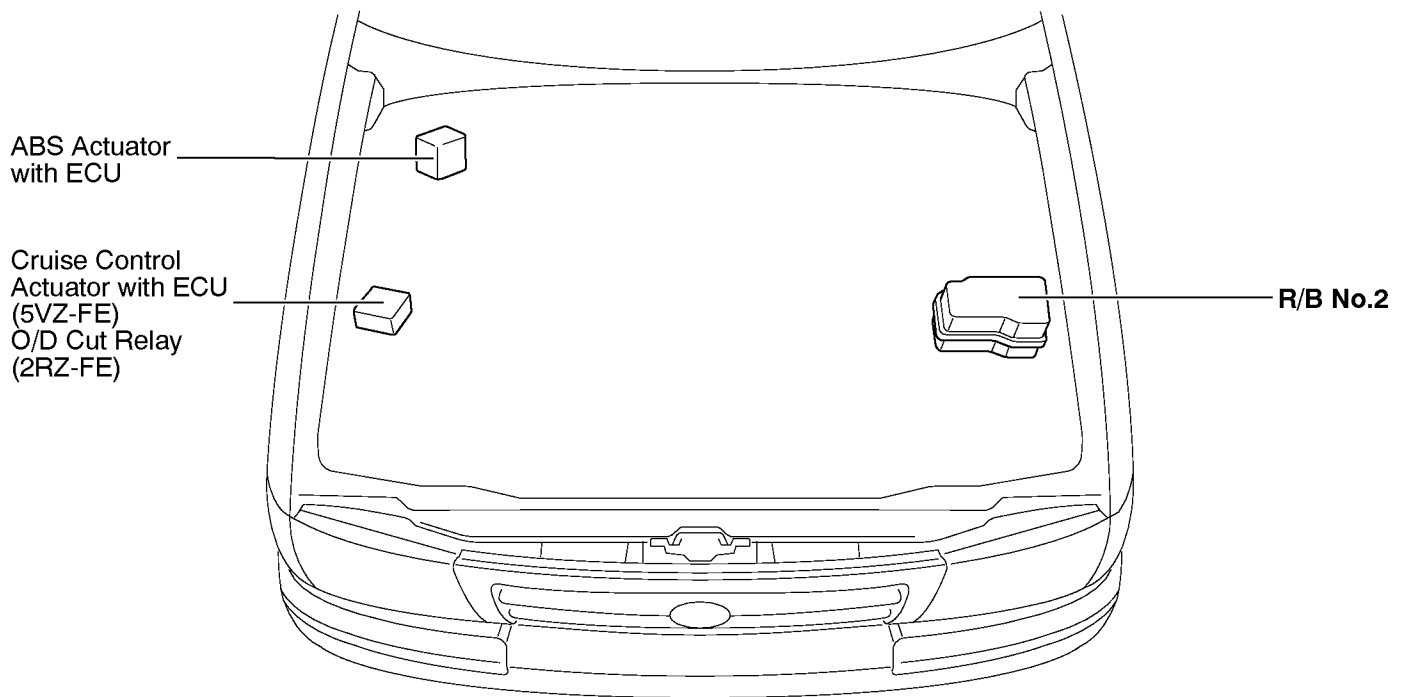

[Instrument Panel]

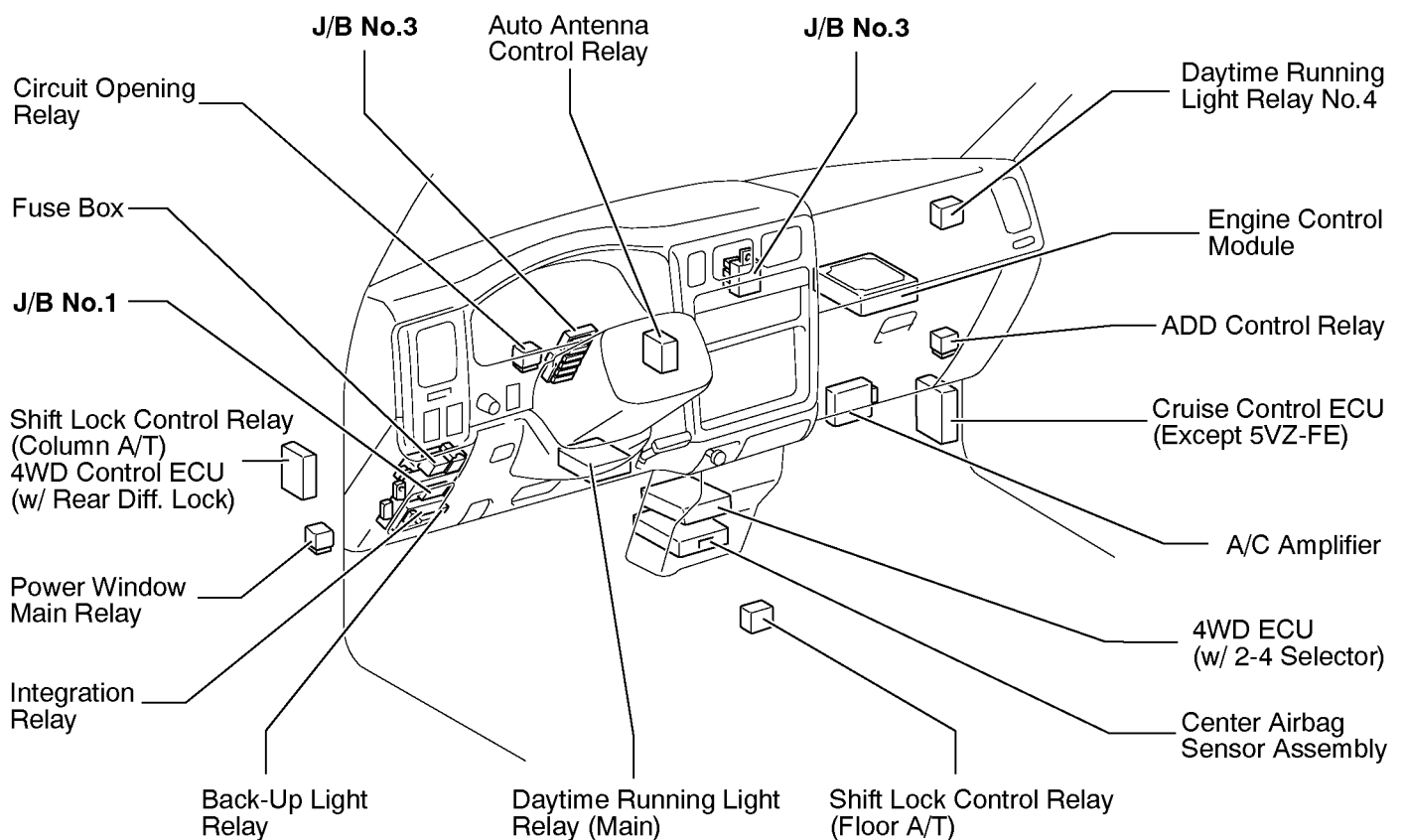

② : R/B No.2

Engine Compartment Left (See Page 20)

- *1 : w/ Daytime Running Light
- *2 : HEAD (HI RH) (w/ Daytime Running Light)
- *3 : HEAD (HI LH) (w/ Daytime Running Light)
- *4 : HEAD (RH) (w/o Daytime Running Light),
HEAD (LO RH) (w/ Daytime Running Light)
- *5 : HEAD (LH) (w/o Daytime Running Light),
HEAD (LO LH) (w/ Daytime Running Light)

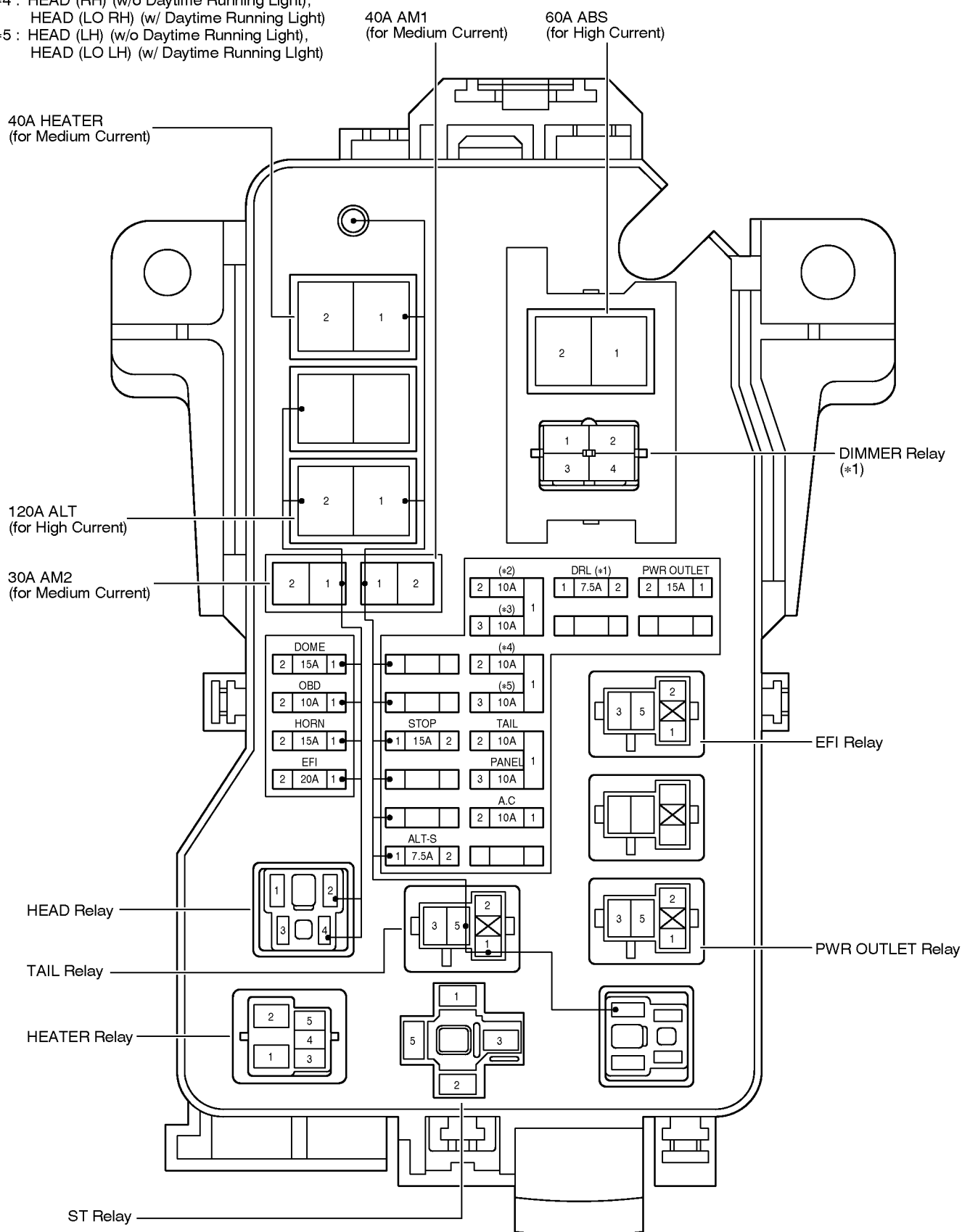

F RELAY LOCATIONS

○ : J/B No.1

Lower Finish Panel (See Page 20)

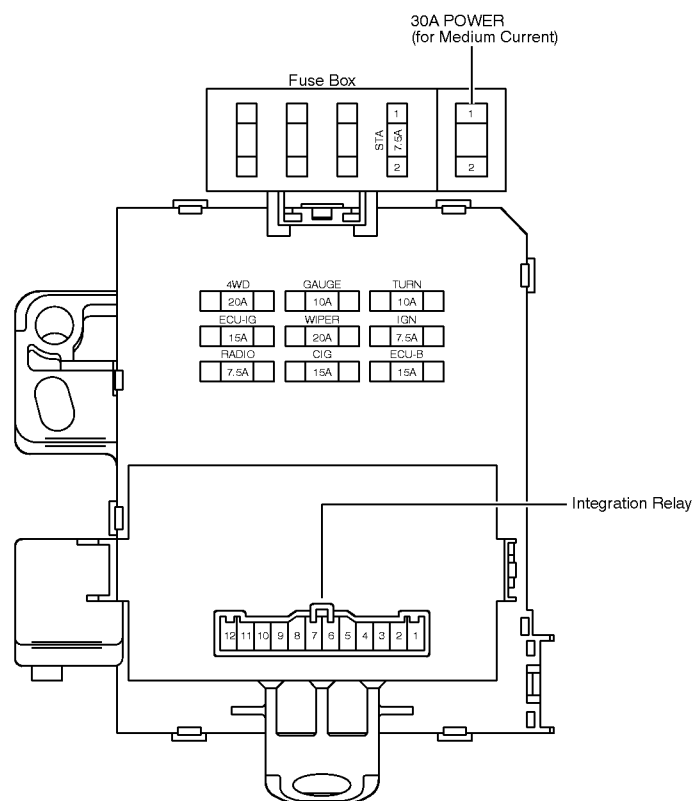
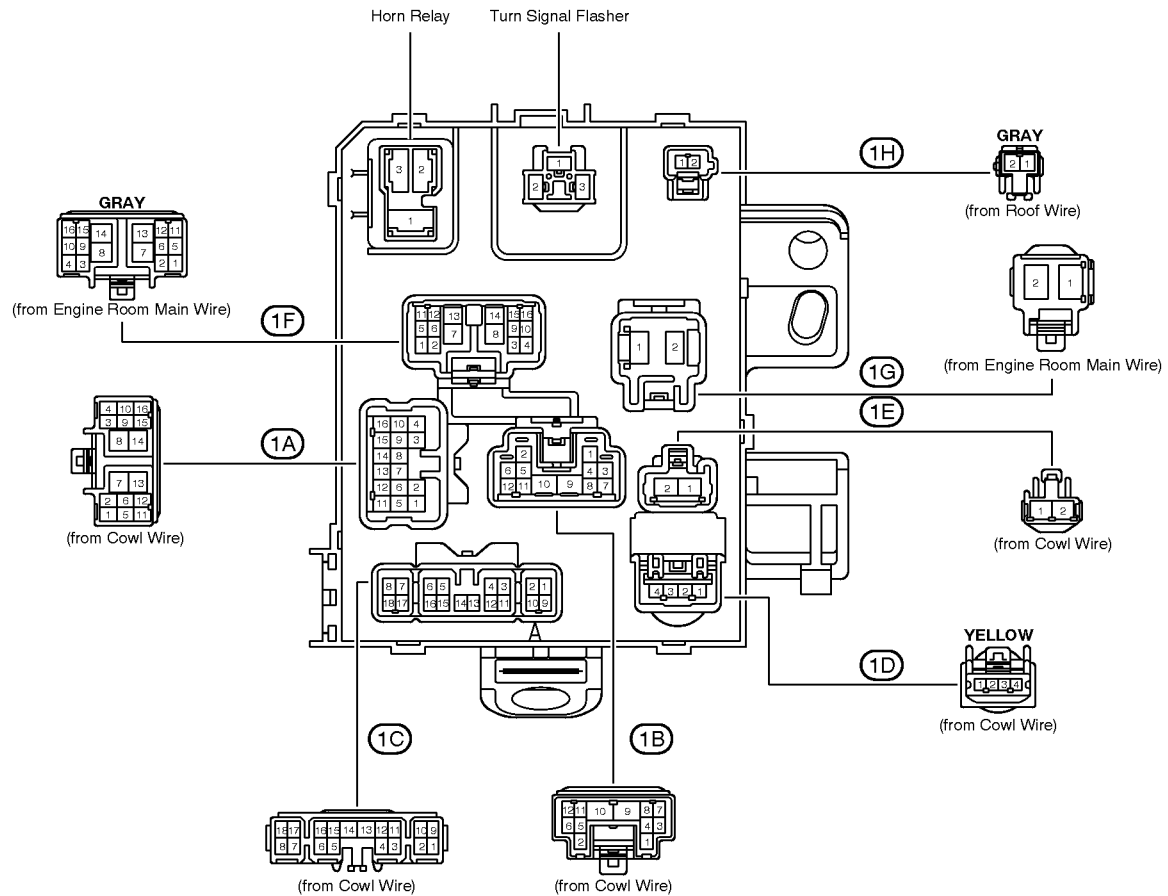

[J/B No.1 Inner Circuit]

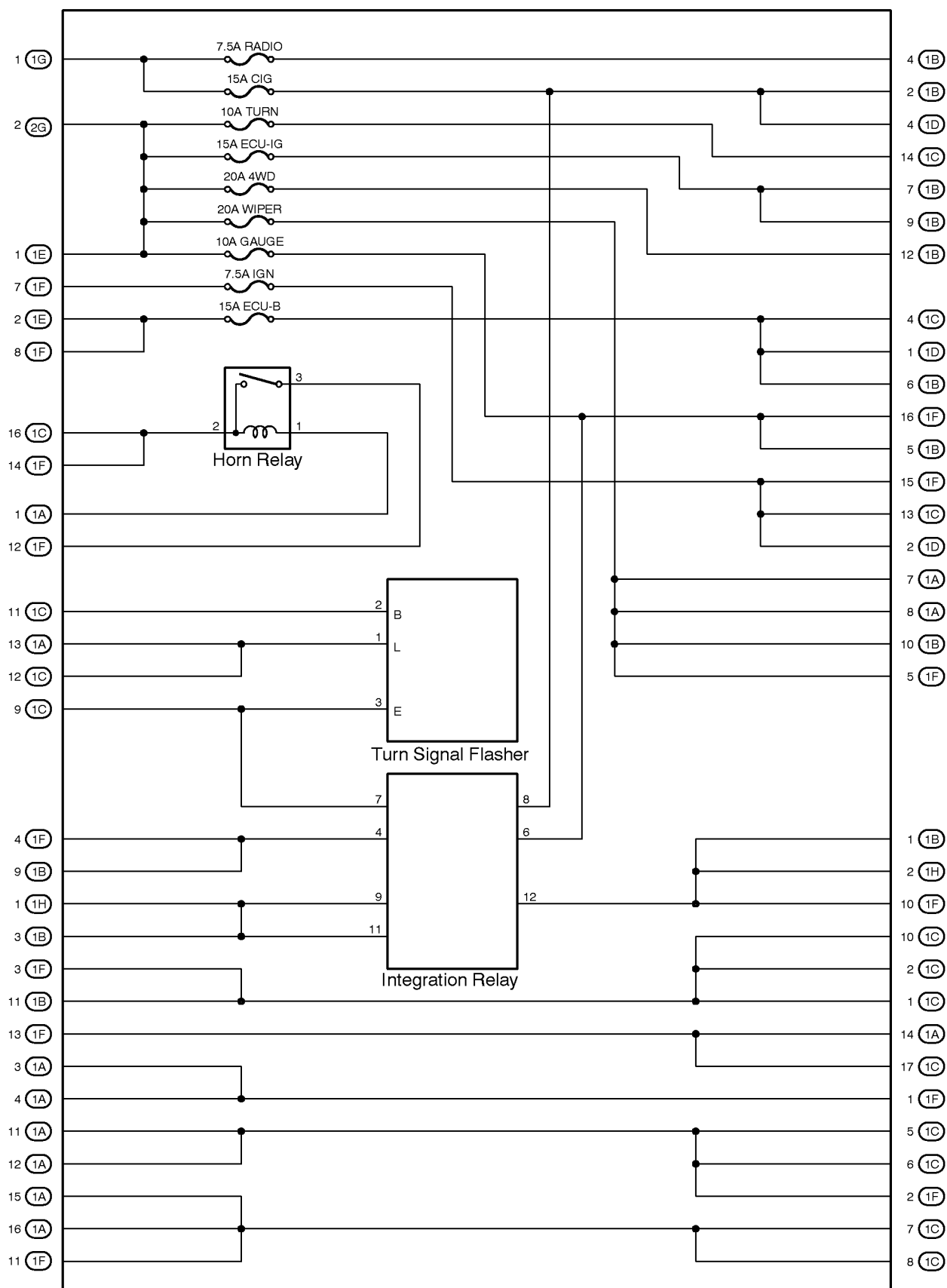

F RELAY LOCATIONS

○ : J/B No.3

Behind the Instrument Panel Left (See Page 20)

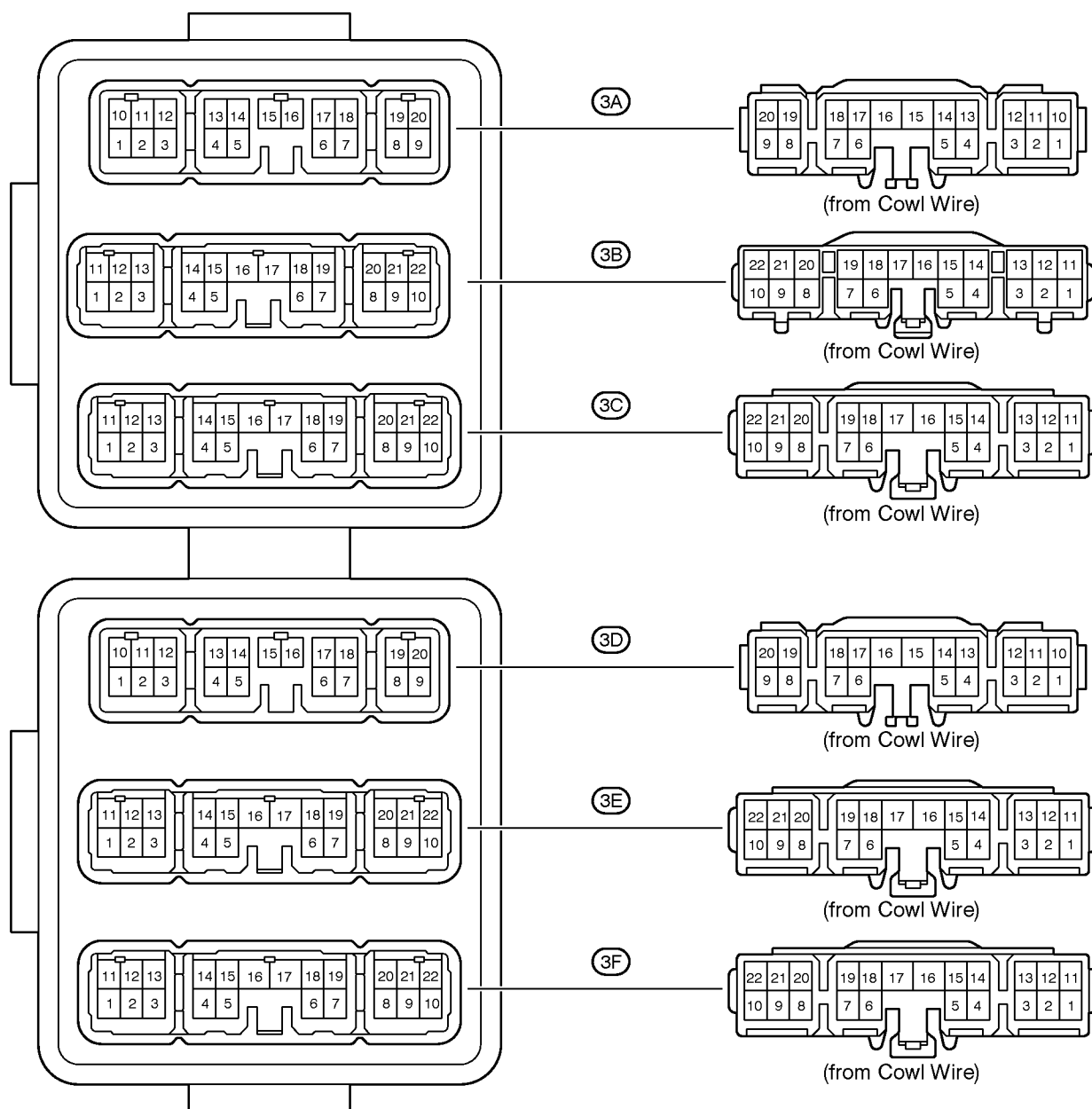

[J/B No.3 Inner Circuit]

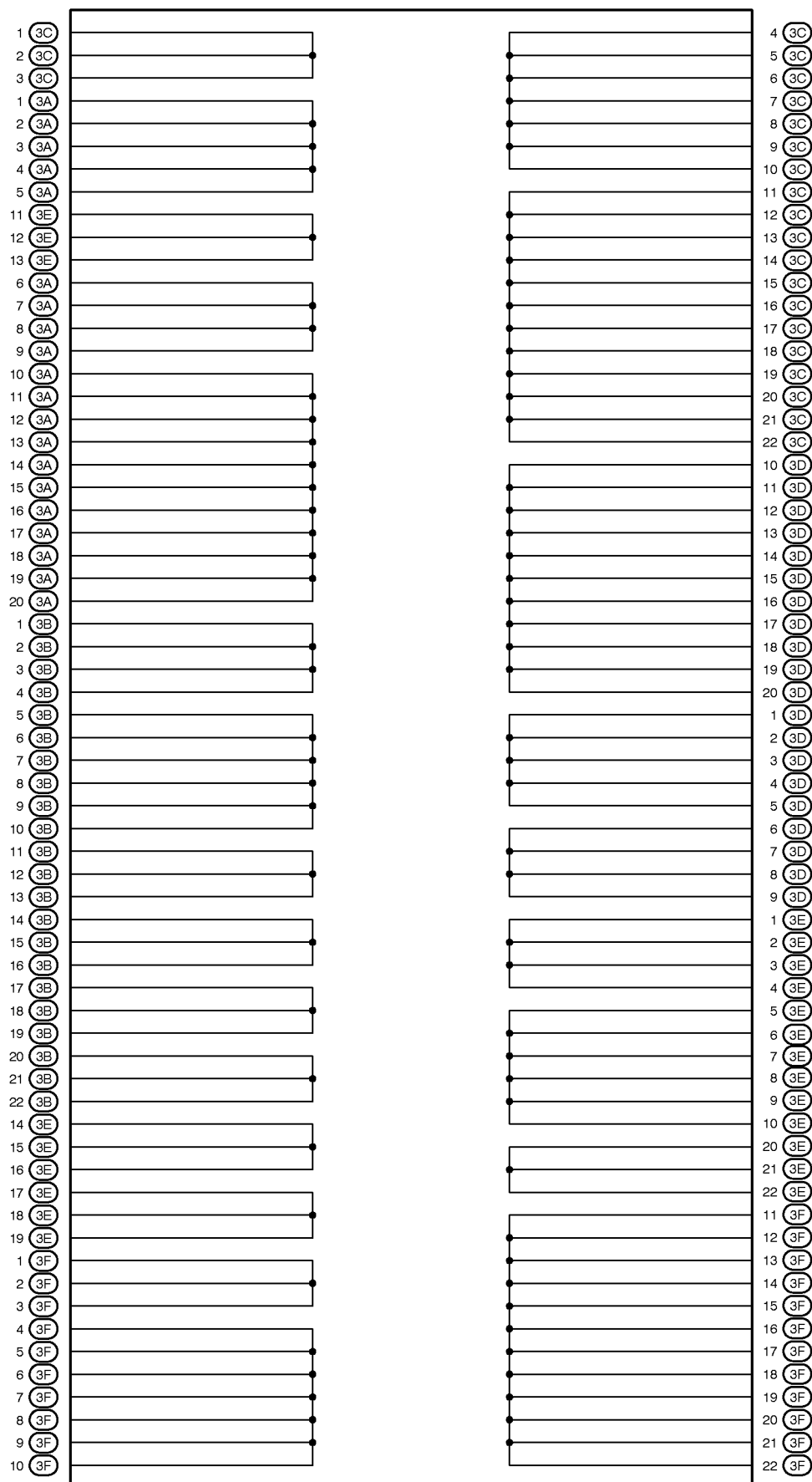

F RELAY LOCATIONS

 : J/B No.3

Behind the Instrument Panel Center (See Page 20)

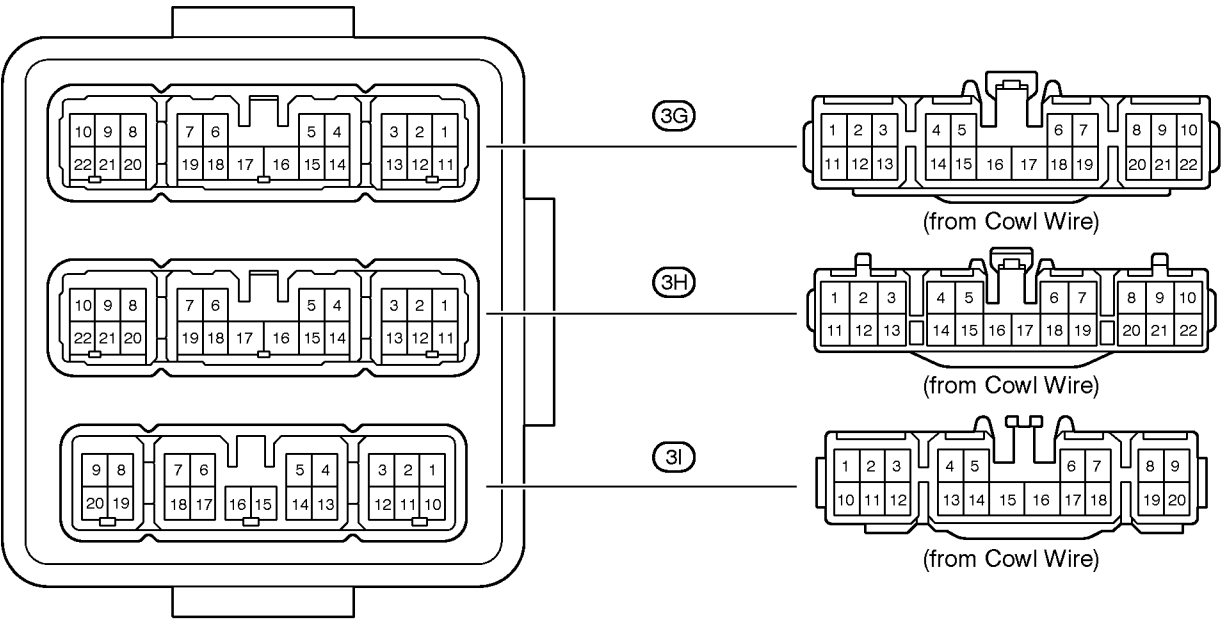

[J/B No.3 Inner Circuit]

